

PART NOS.	P	A	F	f	L	H	Ød
IVI - BV - 4	¼"	63.5	32	25.4	90	27	8
IVI - BV - 6	⅜"	63.5	32	25.4	90	27	8
IVI - BV - 8	½"	79	38	28.5	90	37	9.5

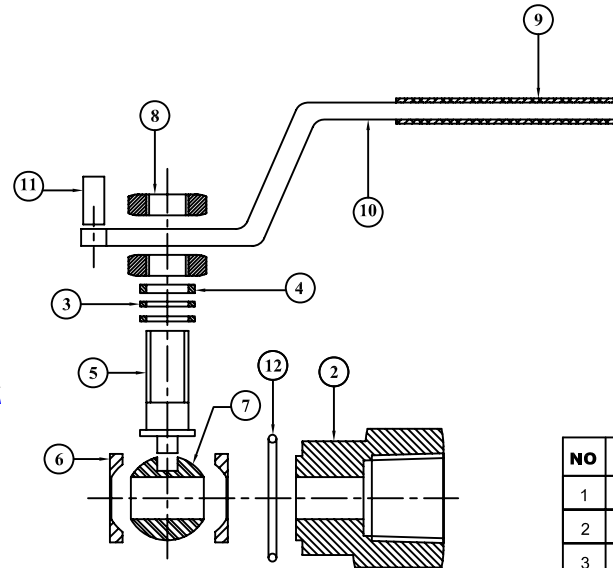
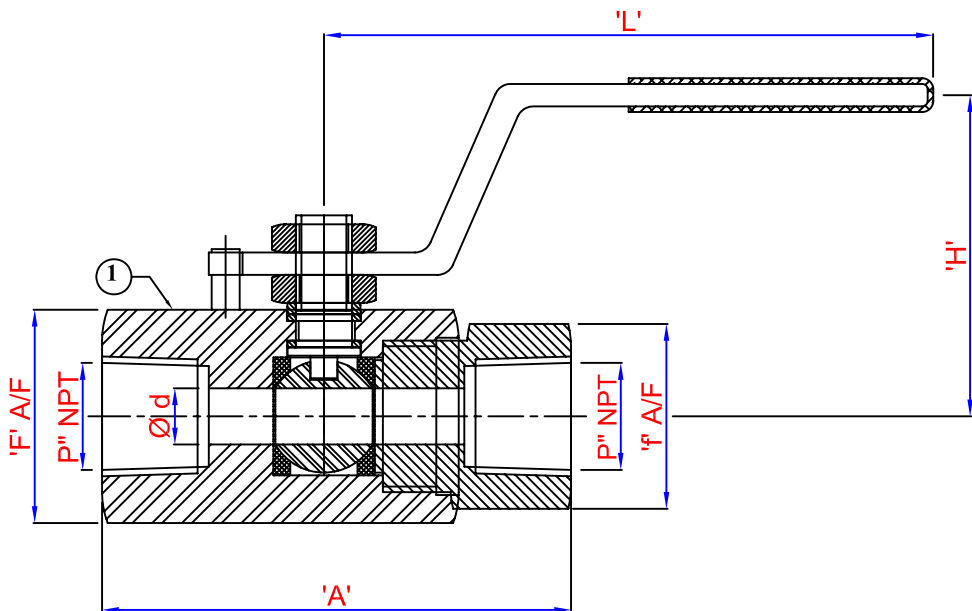

NO	DESCRIPTION	QTY	MATERIAL
1	BODY	1	SS 316
2	ADAPTER	1	SS 316
3	STEM PACKING	2	PTFE
4	STEM WASHER	1	SS 316
5	STEM	1	SS 316
6	BALL SEAL	2	PEEK
7	BALL	1	SS 316
8	HANDLE LOCK NUT	2	SS
9	HANDLE GRIP	1	PVC
10	HANDLE	1	SS
11	STOPPER PIN	1	SS
12	O-RING	1	VITON

TEST PRESSURES:

	HYDRAULIC	PNEUMATIC (NITROGEN)
BODY	9000 PSI	1000 PSI
SEAT	6600 PSI	1000 PSI

NOTES: -

1. VALVE DESIGN AND CONSTRUCTION MEETS APPLICABLE REQUIREMENTS OF STANDARD BS:5351
2. INSPECTION AND TESTING AS PER API-598. PNEUMATIC SEAT TEST WILL BE CARRIED OUT WITH NITROGEN GAS.
3. THESE VALVES HAVE BUBBLE TIGHT SEAT AND BLOW-OUT PROOF STEM DESIGN.
4. TEMPERATURE RATING : 100° C
5. DESIGN, DETAILS, DIMENSIONS AND DRAWING GIVEN HERE ARE OF REPRESENTATIVE NATURE, AND ARE SUBJECT TO MINOR CHANGES IF FOUND NECESSARY, WITHOUT NOTICE.
6. DIFFERENT BALL SEALS USED AS PER PRESSURE REQUIREMENT.
7. DIFFERENT END CONNECTIONS AND MATERIAL GRADES OFFERED ON REQUEST.

SIZE :

BALL VALVE

BY	DATE	DIMENSIONS ARE FOR REFERENCE ONLY & SUBJECT TO CHANGE
DRAWN PRASHANT	25/03/2010	
CHD. RD	25/03/2010	MODEL:- IVI-HEX-BV
APPRD. RD	25/03/2010	



INDUSTRIAL VALVES
MUMBAI - 64